

Here are some tips for painting and installing the badges.

Before masking the badge, make sure the badge is CLEAN. Use some lacquer thinner or Acetone to clean out the letters prior to painting because there may be some left over polishing compound in the letters. Mask off the badge and use a sharp X-acto knife to cut out the letters. I prime the badges using an Adhesion Promoter that can be found at your local auto parts store.



While you are there, pick some spray paint to paint the badges whatever color you want. The low gloss black engine enamel is good if you want to paint them black. After you paint the badges, you can cure the paint quickly by putting them on top of your propane BBQ after your done grilling. Before applying the adhesive to the back of the badge wipe the surface clean with the lacquer thinner or Acetone.

Before you remove the stock badge apply some masking tape below the stock badge and a vertical piece next to the badge between the door and the badge. This is for alignment purpose.



The new badges do not have alignment pins, so by applying masking tape that is level and using the old badge for reference, you should be able to place the aluminum badge level the first time and have it the same location on both sides.

Warm the stock badges up with a hair dryer to help soften the old adhesive. Get a piece of fishing line about 3 ft long and double it over. Then twist the fishing line into a braid that will act like a saw. Slide the fishing line behind the badge and work it back and forth like a saw. Once you have cut into the adhesive about a inch or so, you should be able to get your finger behind the badge and pry it off. If you want to save the badges, use the fishing line to cut more of the adhesive.

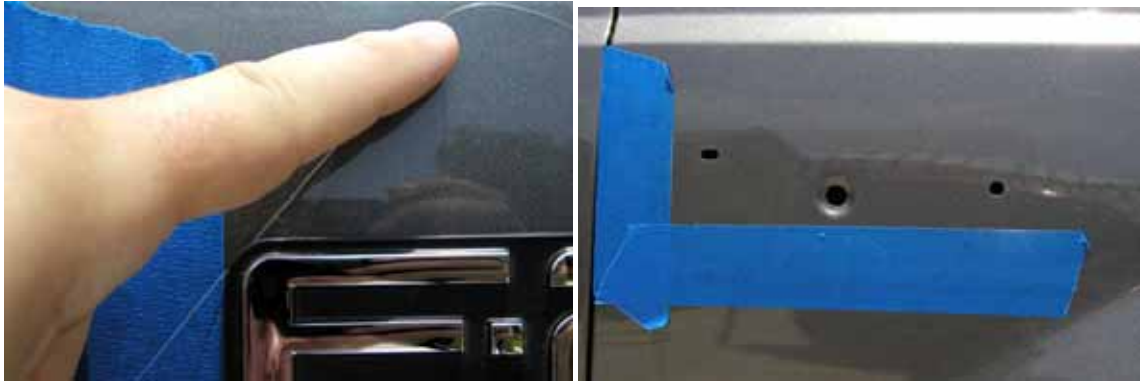

The stock badge has a couple of alignment pins that will stop the fishing line. Note their location in the picture above. You only need to cut enough to be able to start peeling up a corner. A hair dryer will help soften the adhesive and make it easier to pull off.

Clean the fender surface of any remaining adhesive. You may need to use a citrus-based cleaner like Goo Gone to remove remaining adhesive. Once the adhesive is completely removed, clean the paint with a 50/50 blend of water/rubbing alcohol.



You can apply the badge lightly to make sure it is straight and remove it if necessary if it is not straight. Once it is straight, press down on the badge firmly working from the center toward the outside edge.

When you place the new badge the surface temp of the fender needs to be ~50* or more for the adhesive to cure properly. It should cure completely in about 24 hours.

If the finish of the badge becomes dull, clean with a aluminum polish like Mother's. After finish is restored, apply wax to the badge to preserve the finish.

If you have any questions or problems, please e-mail me at maxrsmart@cox.net

Thank you for your order.

Steve Smart.